

**Paper Reference(s)    1DT0/1F**  
**Pearson Edexcel Level 1/Level 2 GCSE**  
**(9–1)**

**Design and Technology**  
**COMPONENT 1: Timbers**

**Monday 19 June 2023 – Morning**

**Diagram Booklet**

**In the boxes below, write your name, centre number and candidate number.**

<b>Surname</b>					
<b>Other names</b>					
<b>Centre Number</b>					
<b>Candidate Number</b>					

## **INSTRUCTIONS**

**There may be spare copies of some diagrams in case you need them.**

**THIS DIAGRAM BOOKLET MUST BE  
RETURNED WITH THE QUESTION PAPER  
AT THE END OF THE EXAMINATION.**

# **Contents**

## **Page**

<b>5–6</b>	<b>Question 1(a)</b>
<b>7</b>	<b>Question 2</b>
<b>8</b>	<b>Question 2(c)</b>
<b>9–10</b>	<b>Question 2(d)</b>
<b>11</b>	<b>Question 3</b>
<b>12</b>	<b>Question 3(d)</b>
<b>13</b>	<b>Question 4</b>
<b>14–15</b>	<b>Question 5(a)</b>
<b>16</b>	<b>Question 5(a) – Outline</b>
<b>17</b>	<b>Question 5(b)</b>
<b>18</b>	<b>Question 6(a)</b>
<b>19</b>	<b>Question 6(b)</b>
<b>20</b>	<b>Question 7(a)</b>
<b>21</b>	<b>Question 7(b)</b>

**(continued on the next page)**

## **Contents continued.**

- 22        Question 7(c) –  
(NOT accurately drawn)**
- 23        Question 7(c) – 5mm isometric grid**
- 24        Question 8**
- 25        Question 8(d)**
- Spare Copies**
- 26–27   Question 1(a)**
- 28        Question 5(a) – Outline**
- 29        Question 7(c) – 5mm isometric grid**

Question 1(a)

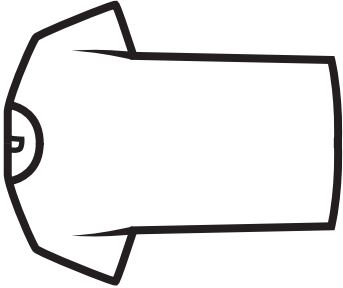
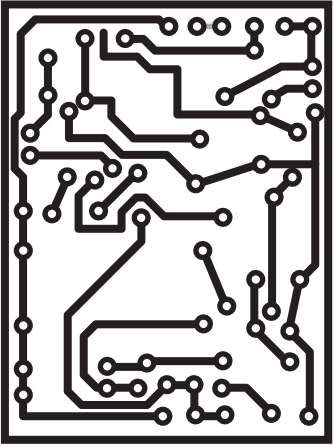
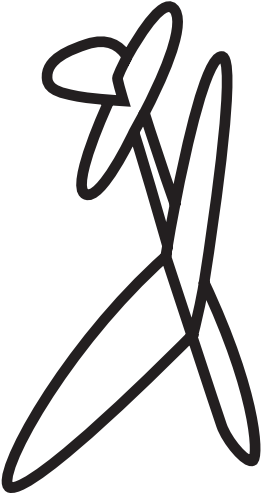
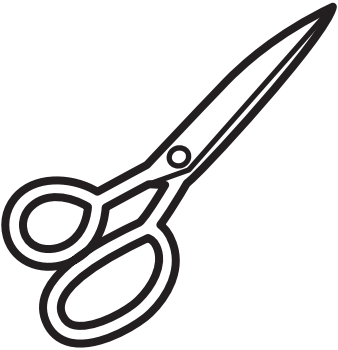

Figure 1

Picture of product	Material and product	Property
	Cotton T-shirt	Soft
	Polyester resin printed circuit board (PCB)	(i) _____
	Balsa wood toy plane	(ii) _____

(continued on the next page)

Turn over

Question 1(a) continued

Picture of product	Material and product	Property
	Stainless steel kitchen scissors	(iii) _____
	Solid white board hardback book cover	(iv) _____

## Question 2

**FIGURE 2**

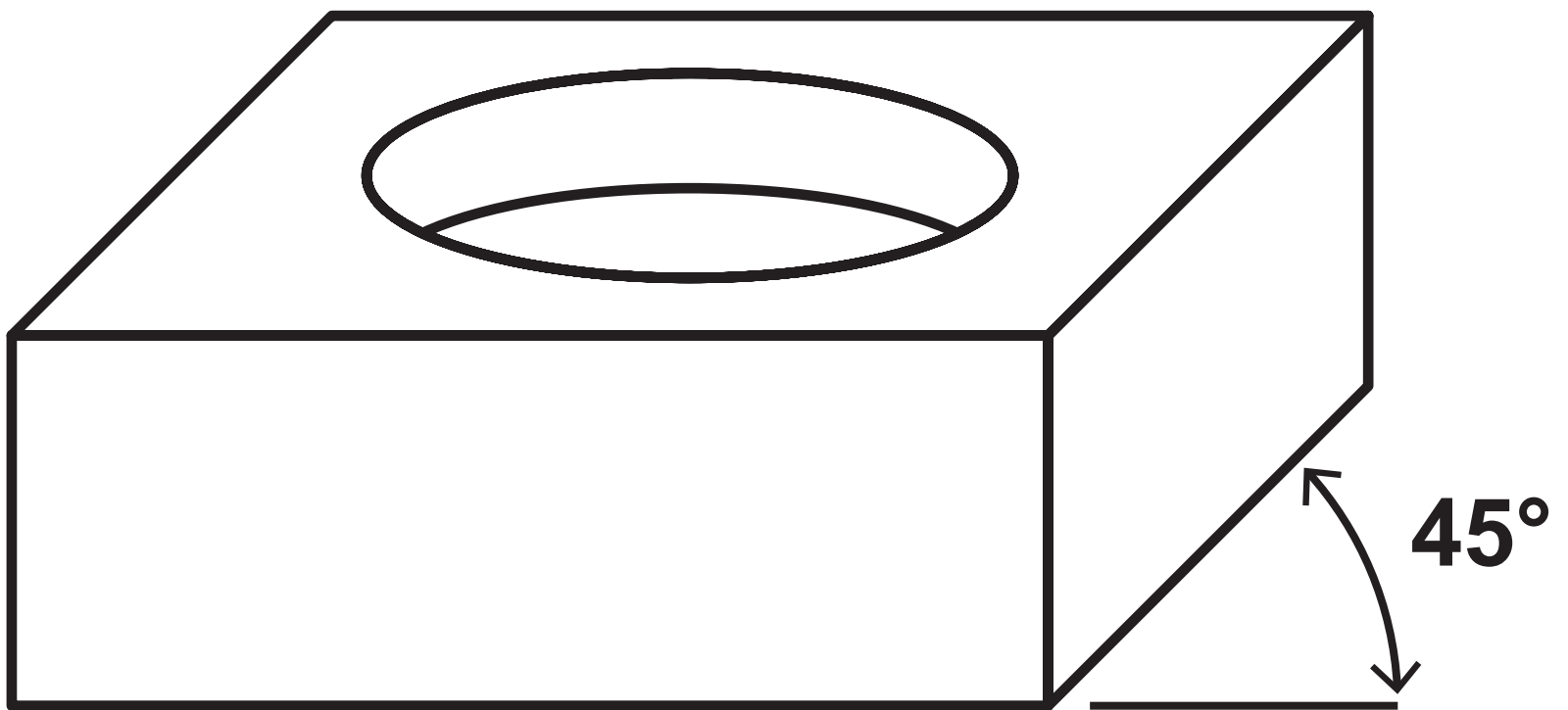

## Question 2(c)

### FIGURE 3

All dimensions in mm

Ø – diameter

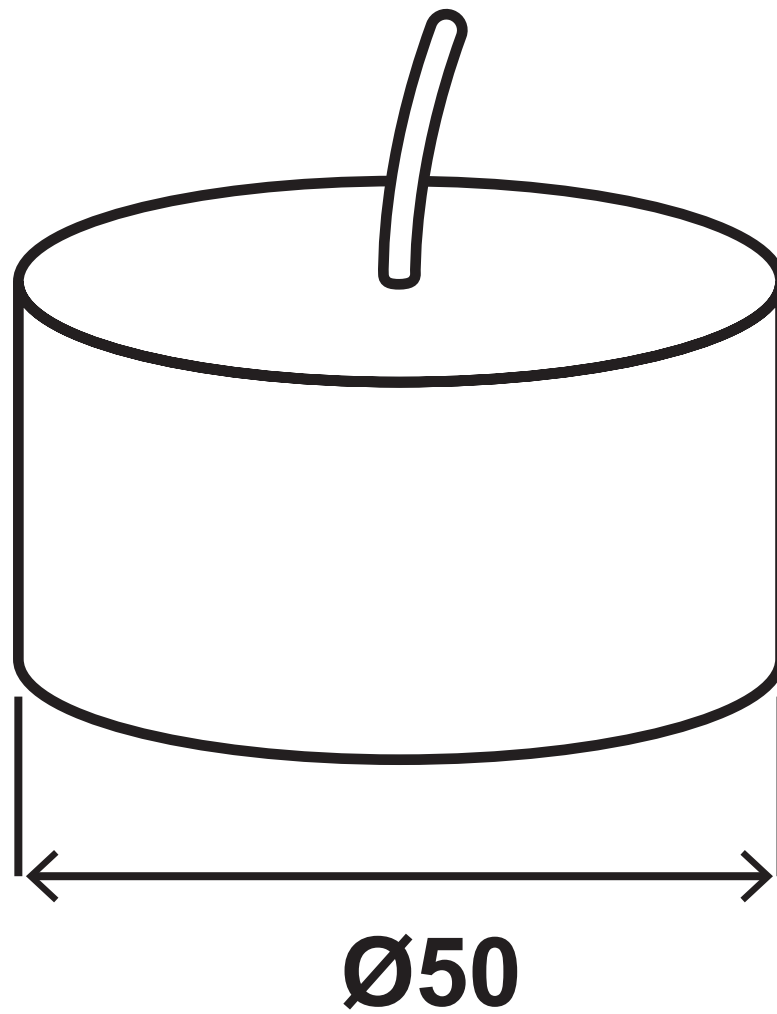



Question 2(d)

FIGURE 4

All

dimensions  
in mm

Volume of cylinder =  $\pi \times r^2 \times h$     Use  $\pi = 3.142$

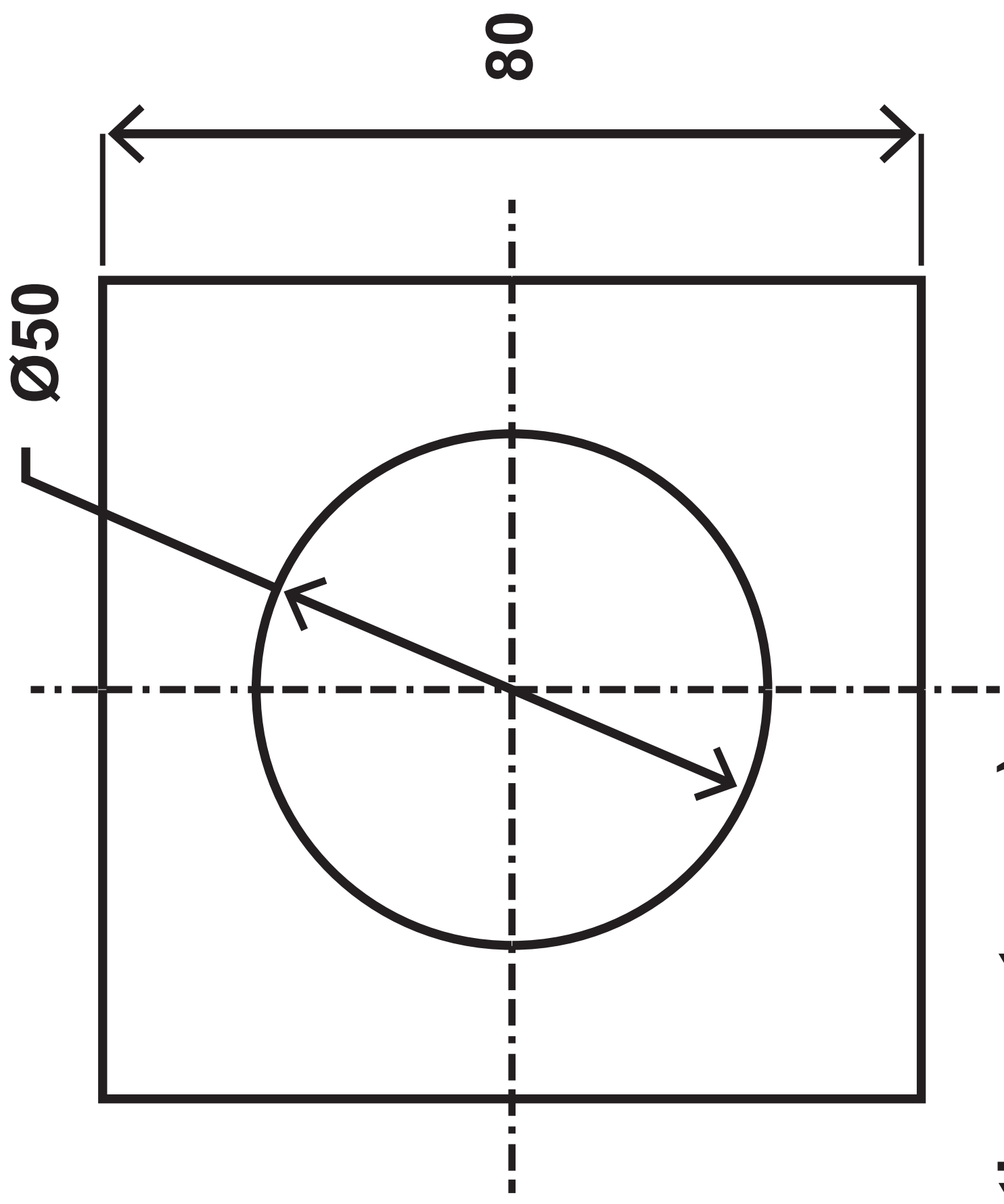

(continued on the next page)

Turn over

Question 2(d) continued.

FIGURE 4

All dimensions      Volume of cylinder

Use  $\pi =$

in mm       $= \pi \times r^2 \times h$

3.142

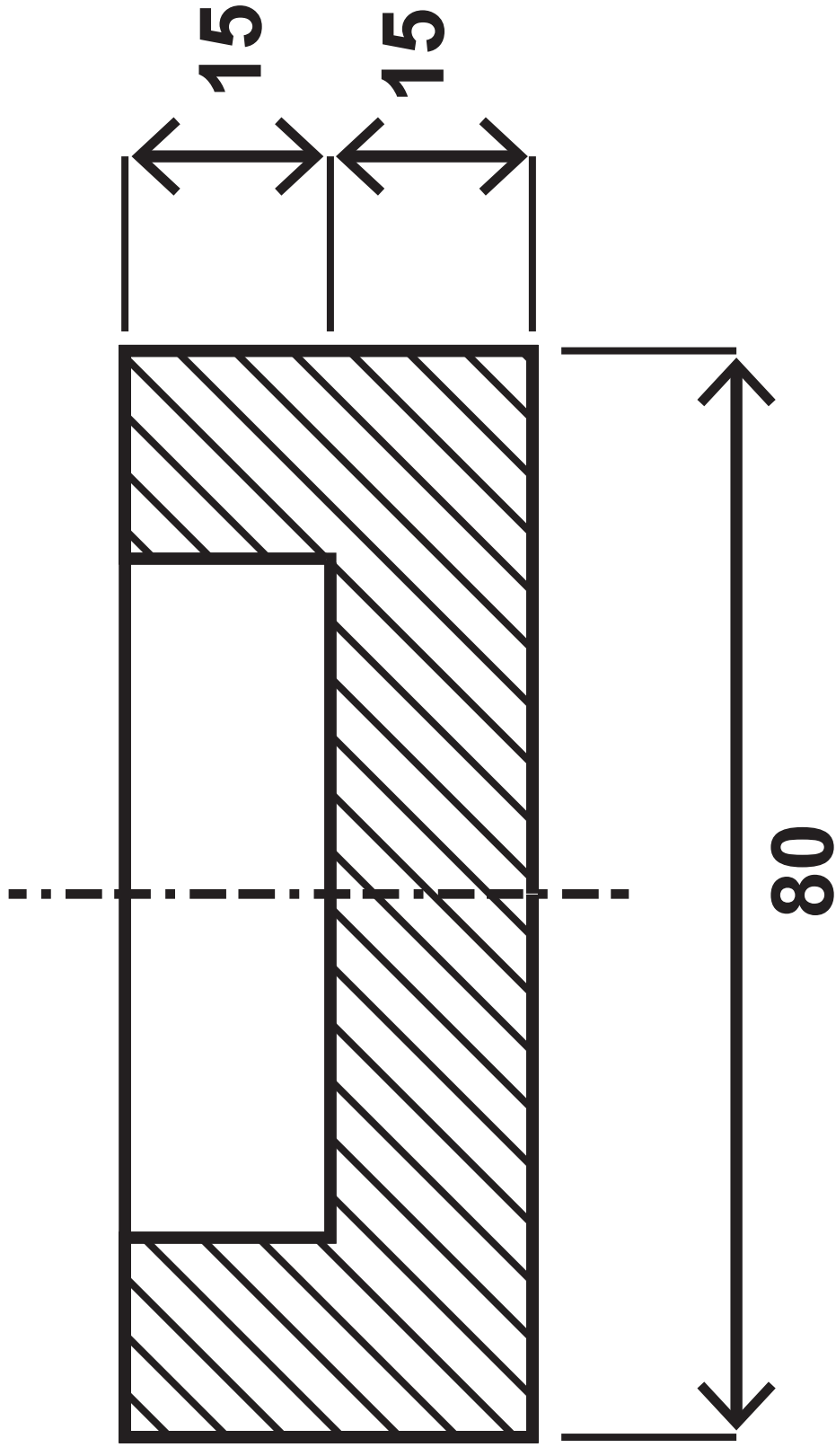

## Question 3

**FIGURE 5**

**Vegetable  
growing  
frame**

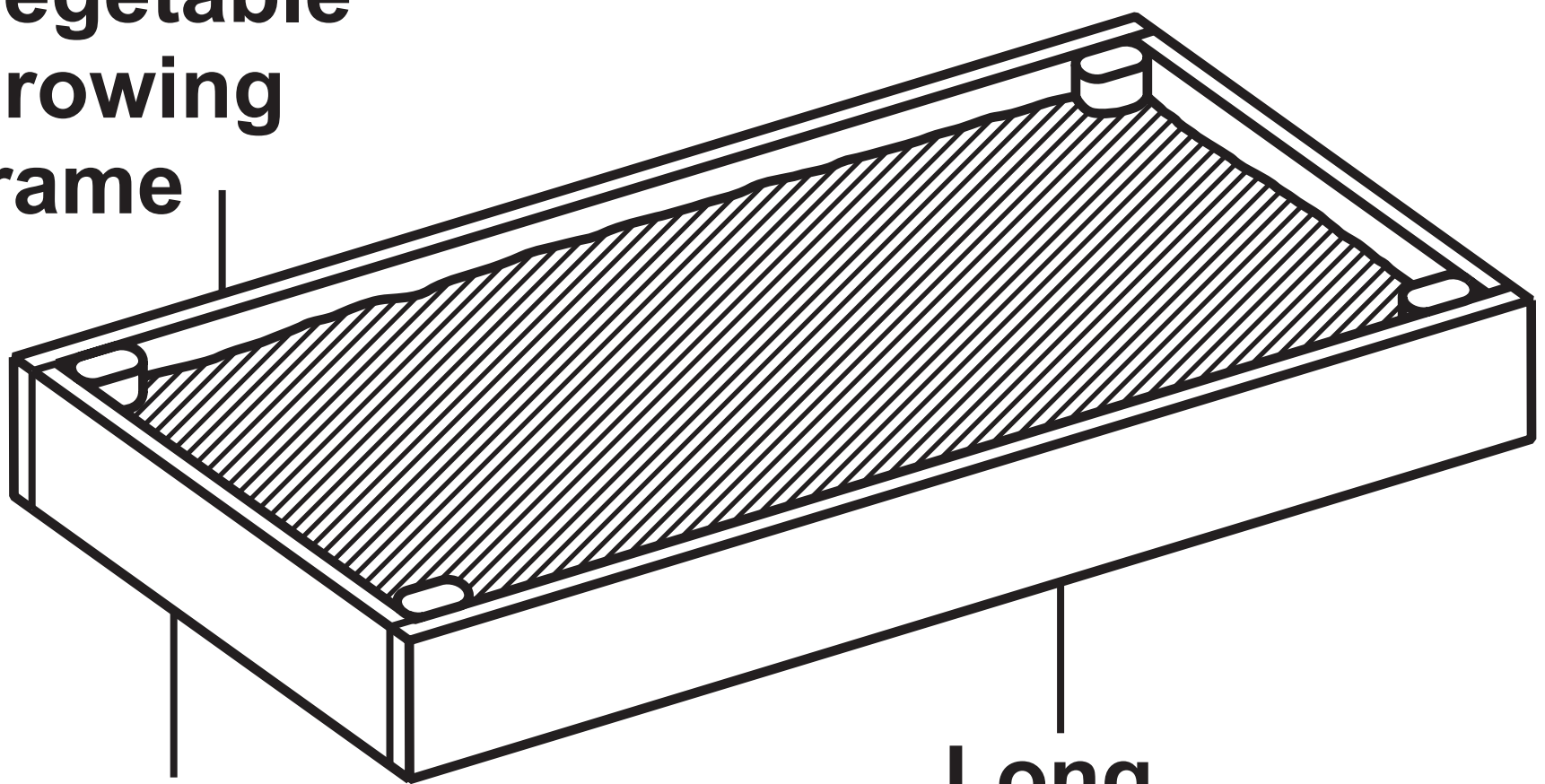

**Short  
side**

**Long  
side**

## Question 3(d)

**FIGURE 6**

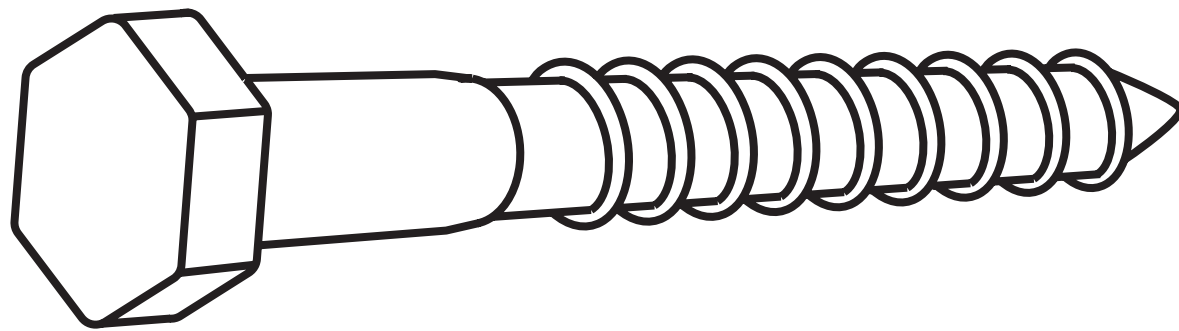

## Question 4

**FIGURE 7**



FIGURE 8

All dimensions in mm

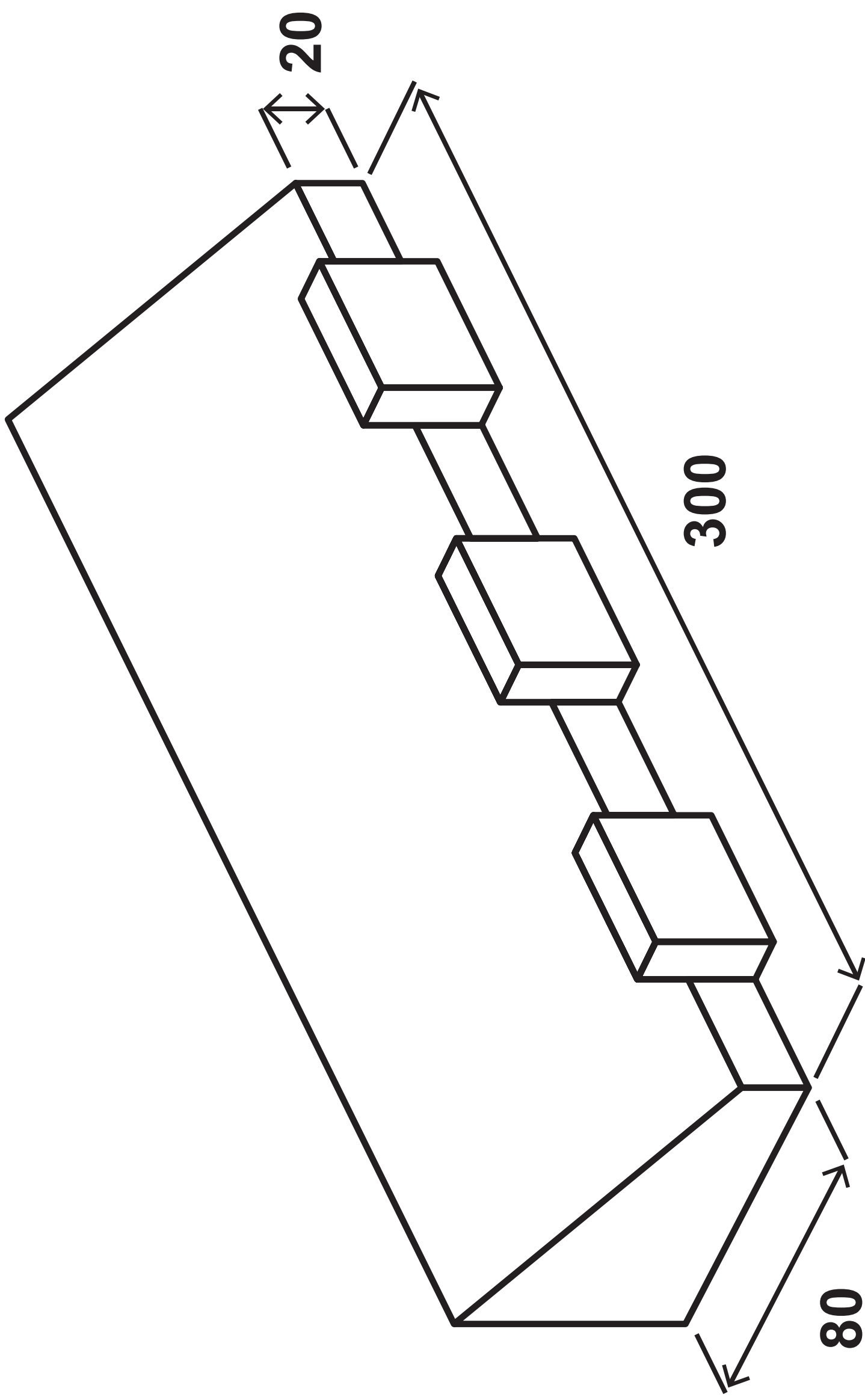

(continued on the next page)

Turn over

**Question 5(a) continued.**

**FIGURE 8**

**Additional information – dimensions of box of chocolates**  
**All dimensions in mm**

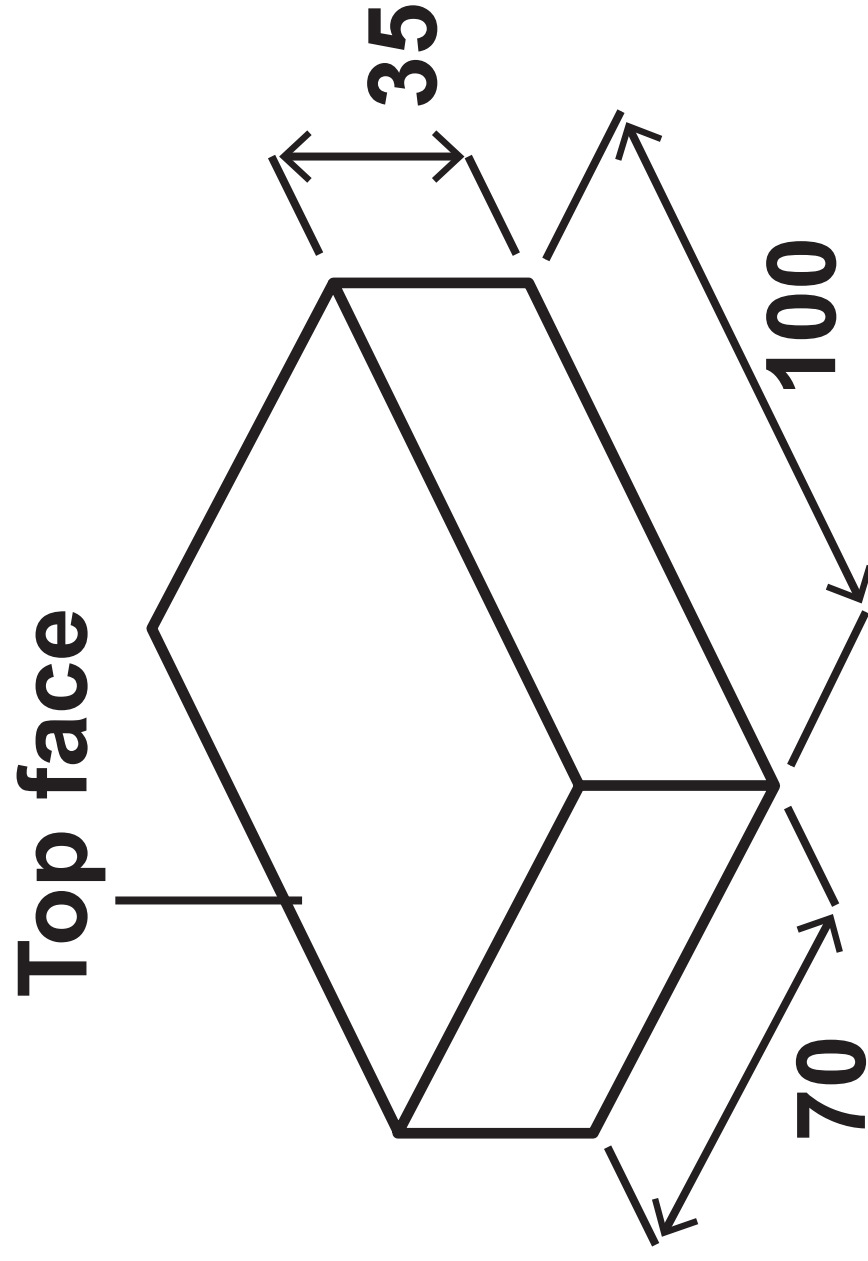

## Question 5(a) – Outline

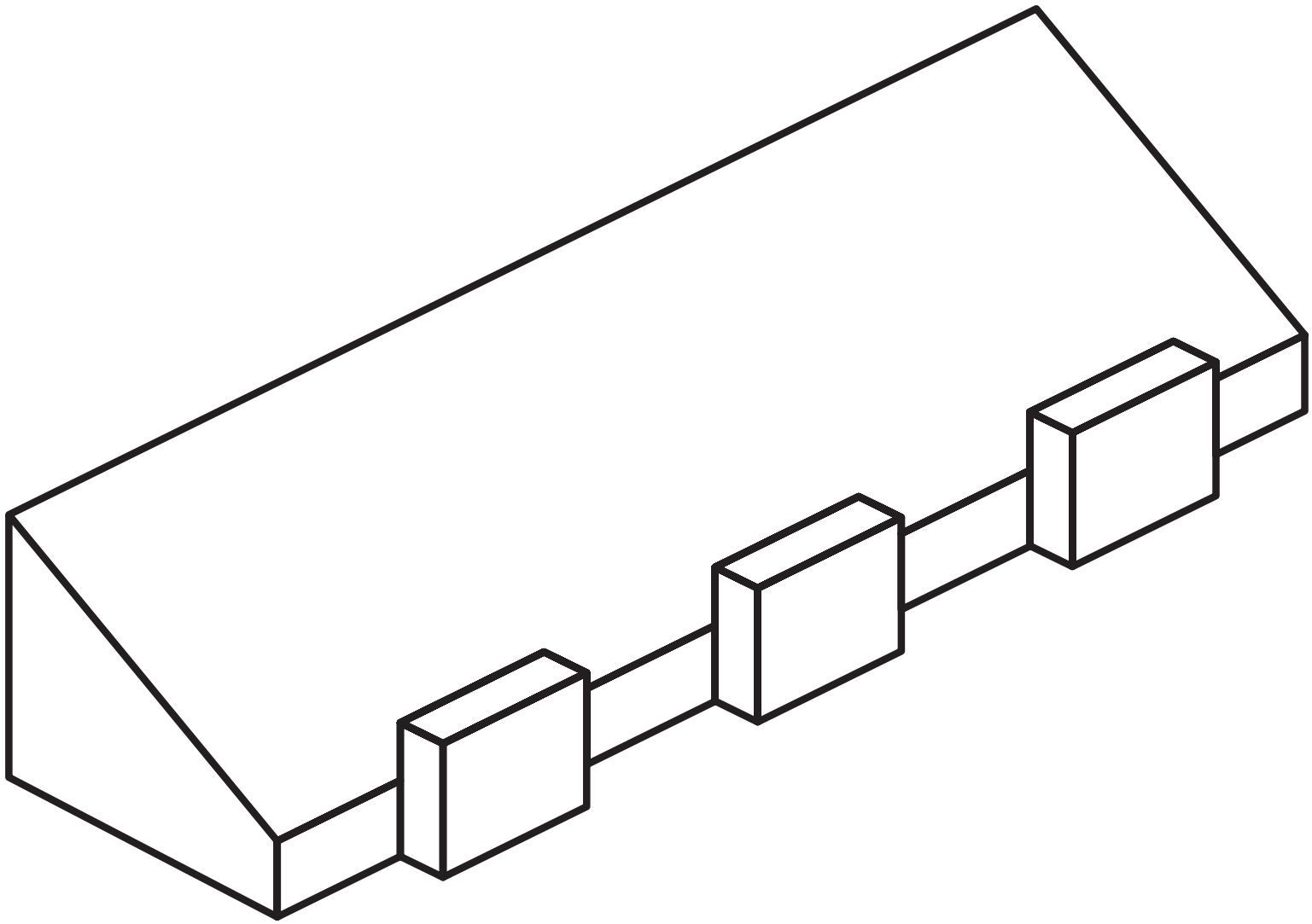



Question 5(b)

**FIGURE 9**  
**Clear acrylic screen**

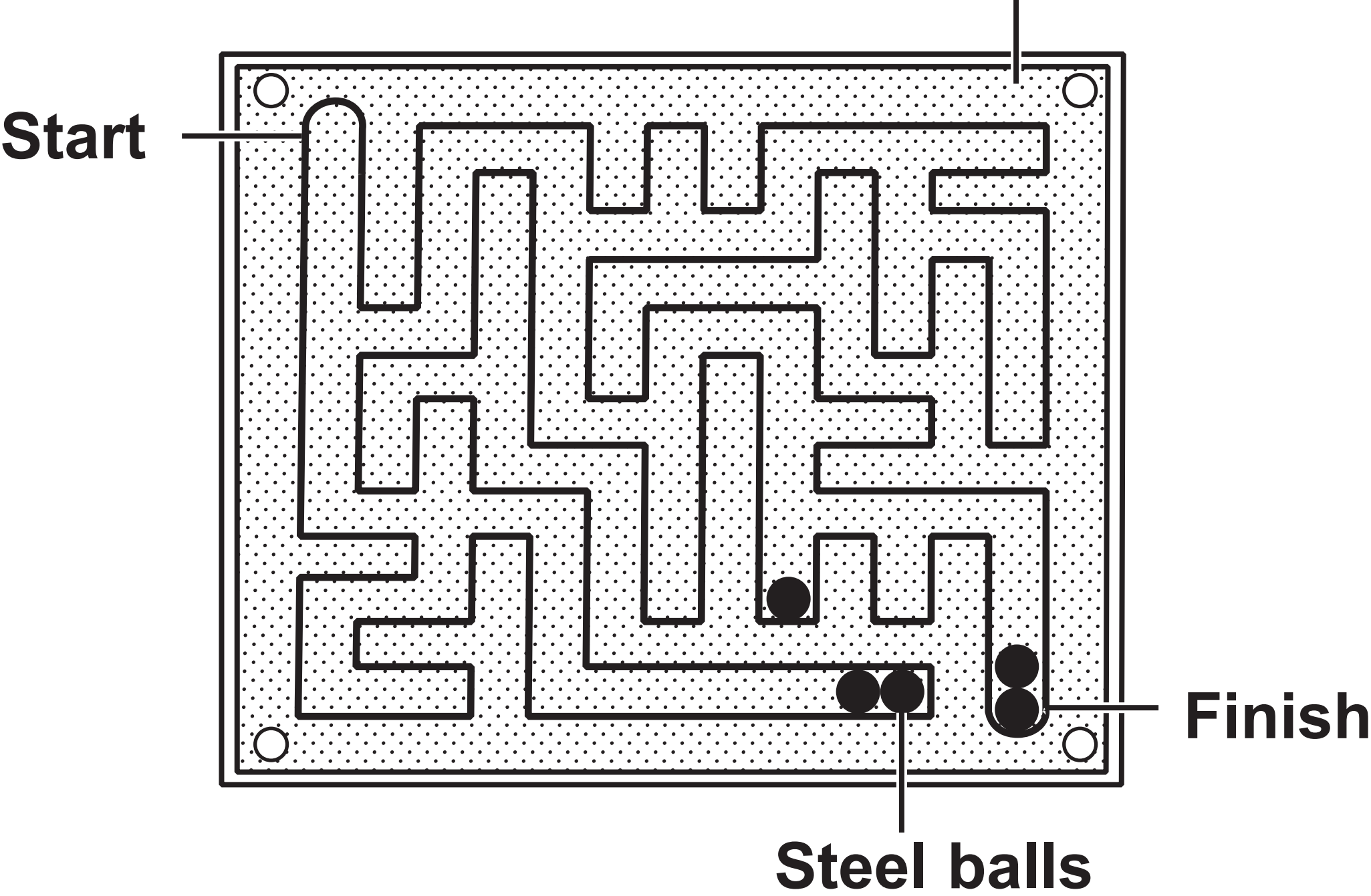
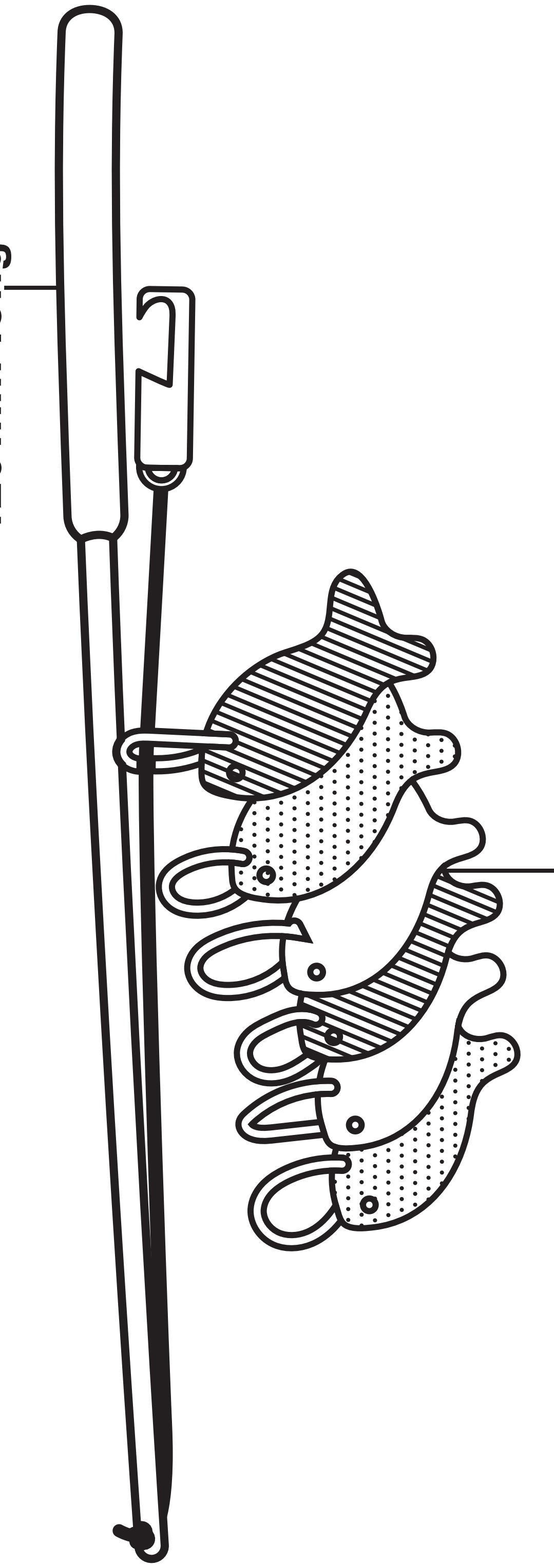
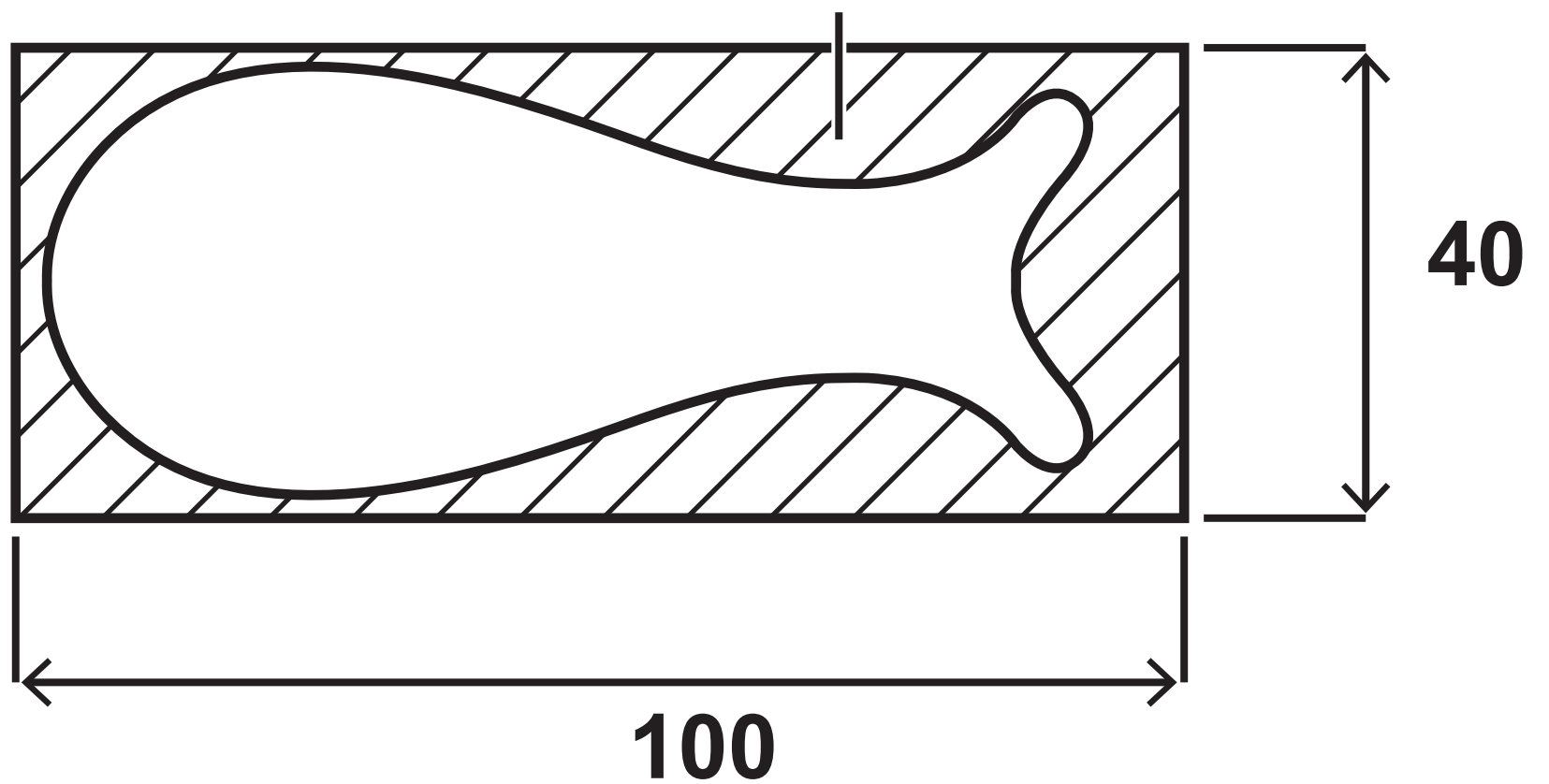

FIGURE 10

Cylindrical jelutong  
fishing rod handle  
120 mm long



Plywood fish painted yellow,  
green, red or blue

**Question 6(b)****FIGURE 11****All dimensions in mm****Waste**

## Question 7(a)

FIGURE 12

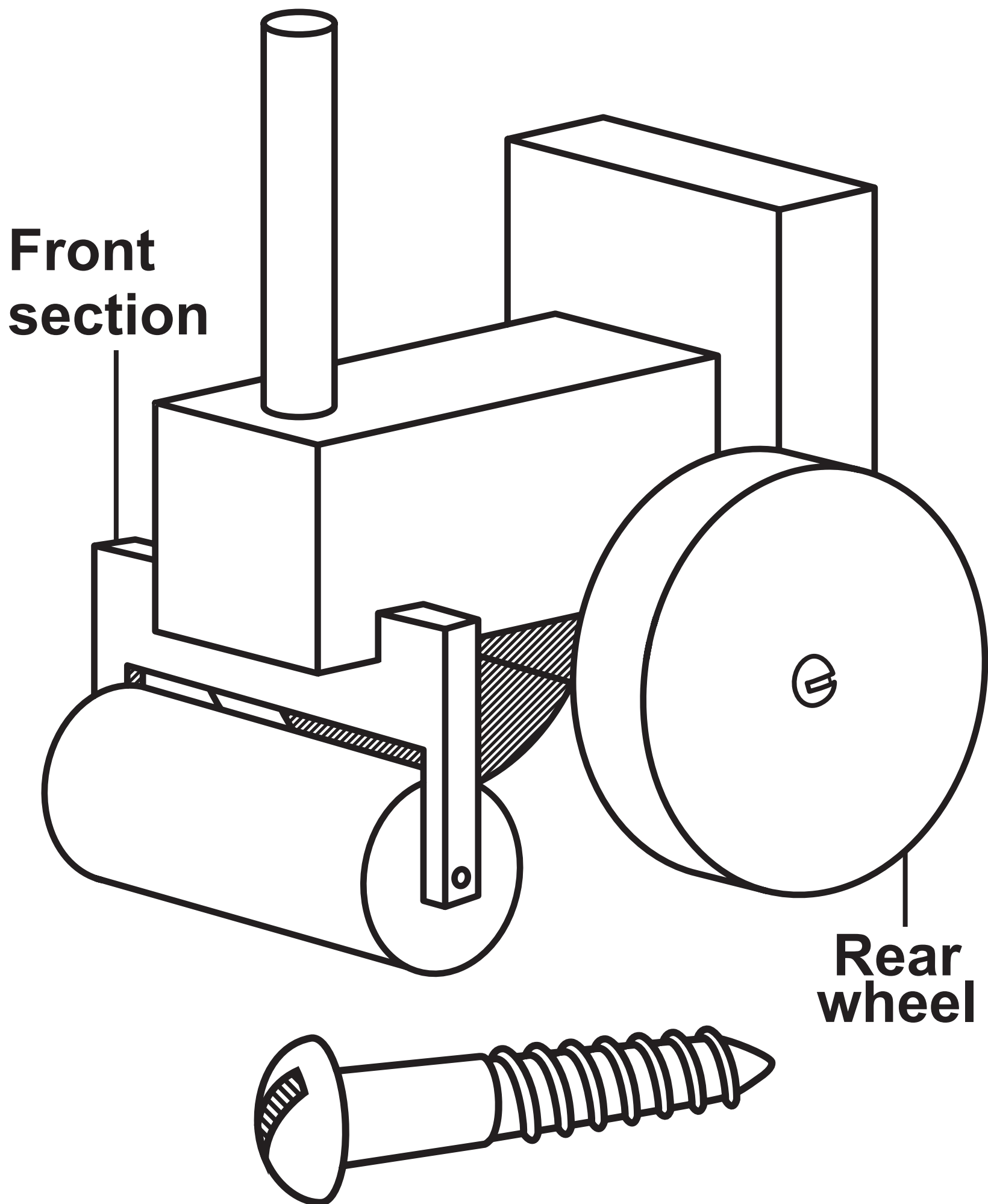

Question 7(b)

FIGURE 13

All dimensions in mm

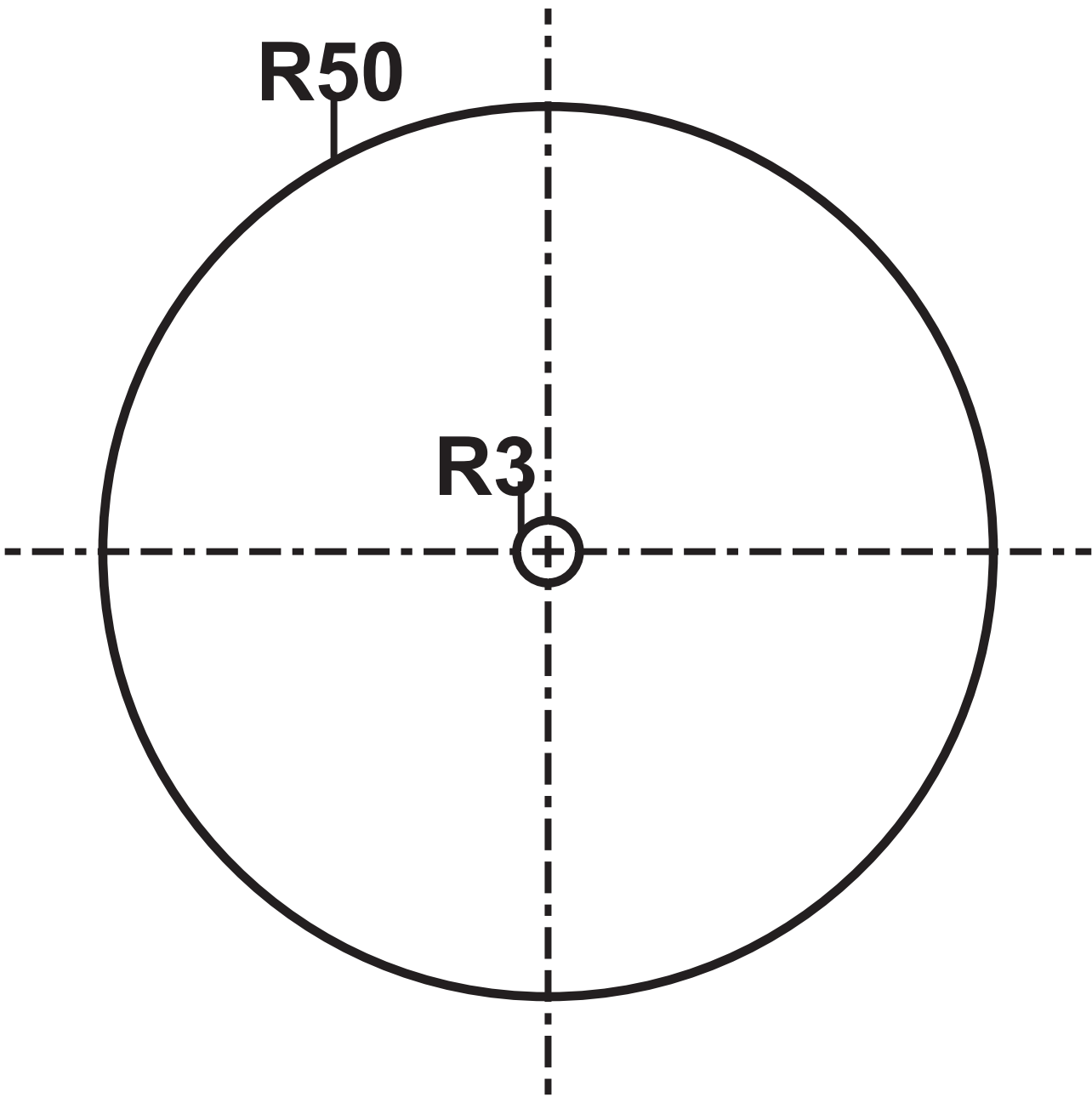

**Question 7(c)**

**FIGURE 14**

**All dimensions in mm**

**Diagram not to scale**

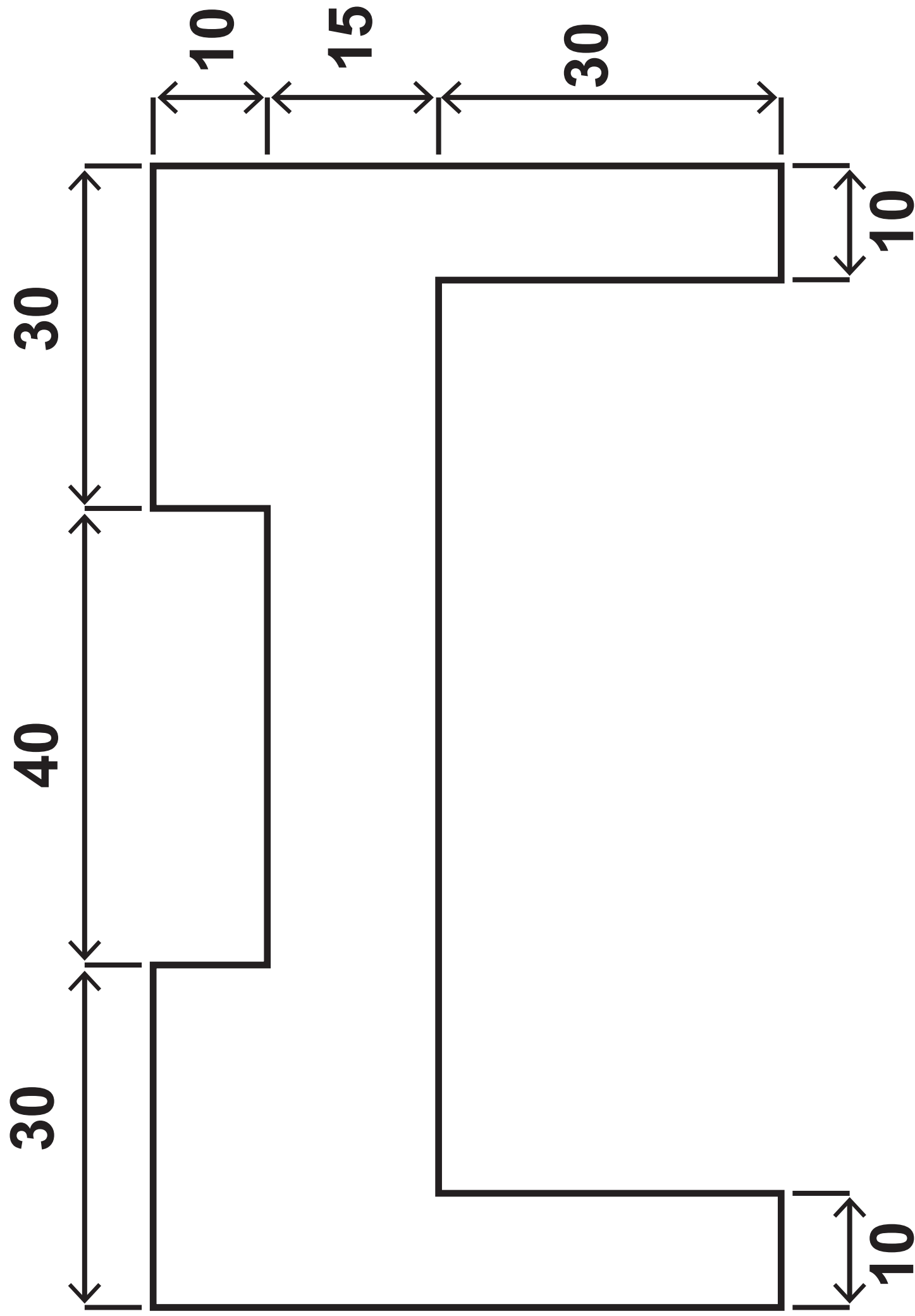

**Isometric grid provided on the next page**

**Question 7(c) continued.**

**5mm isometric grid**

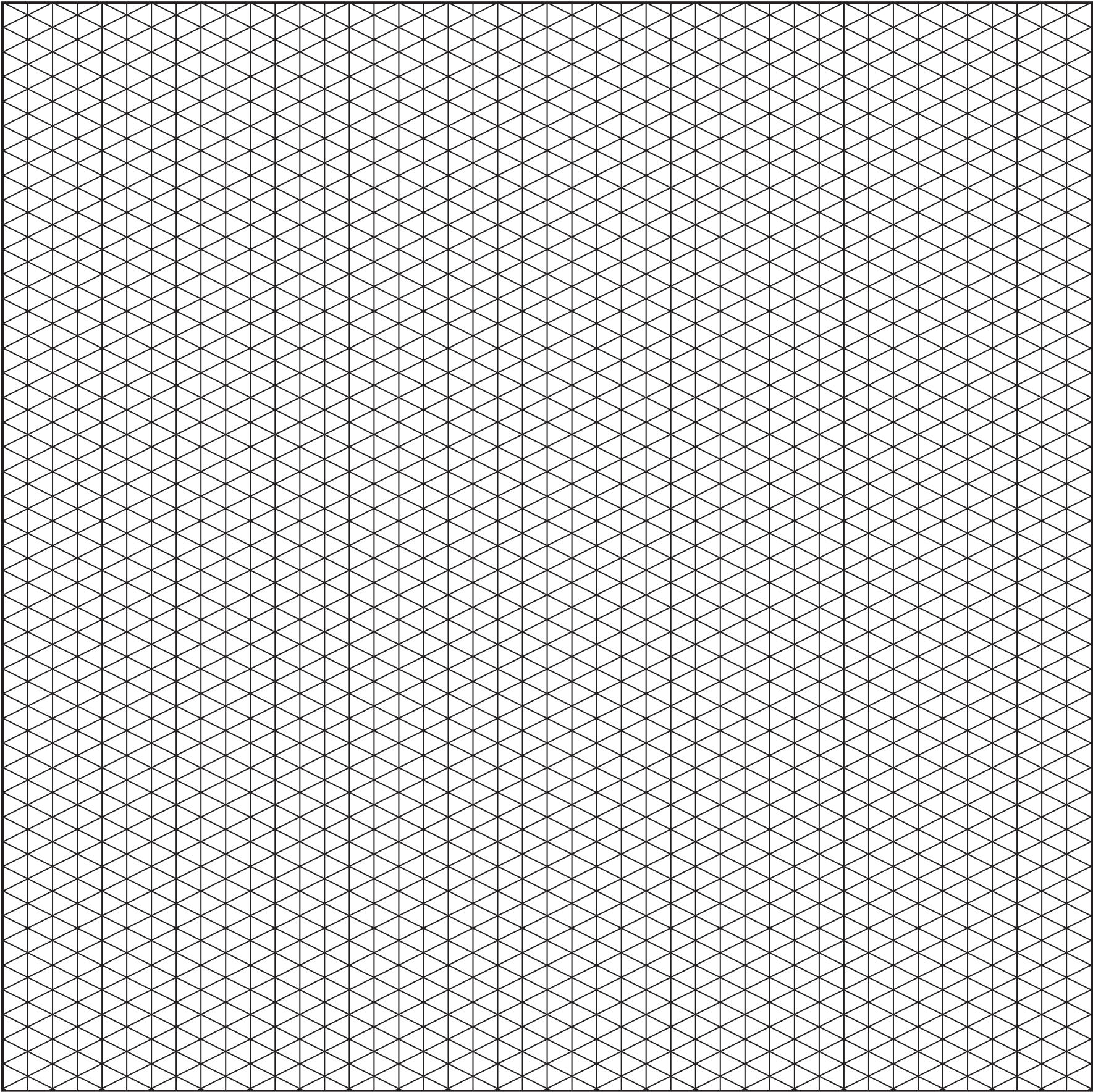

## Question 8

**FIGURE 15**

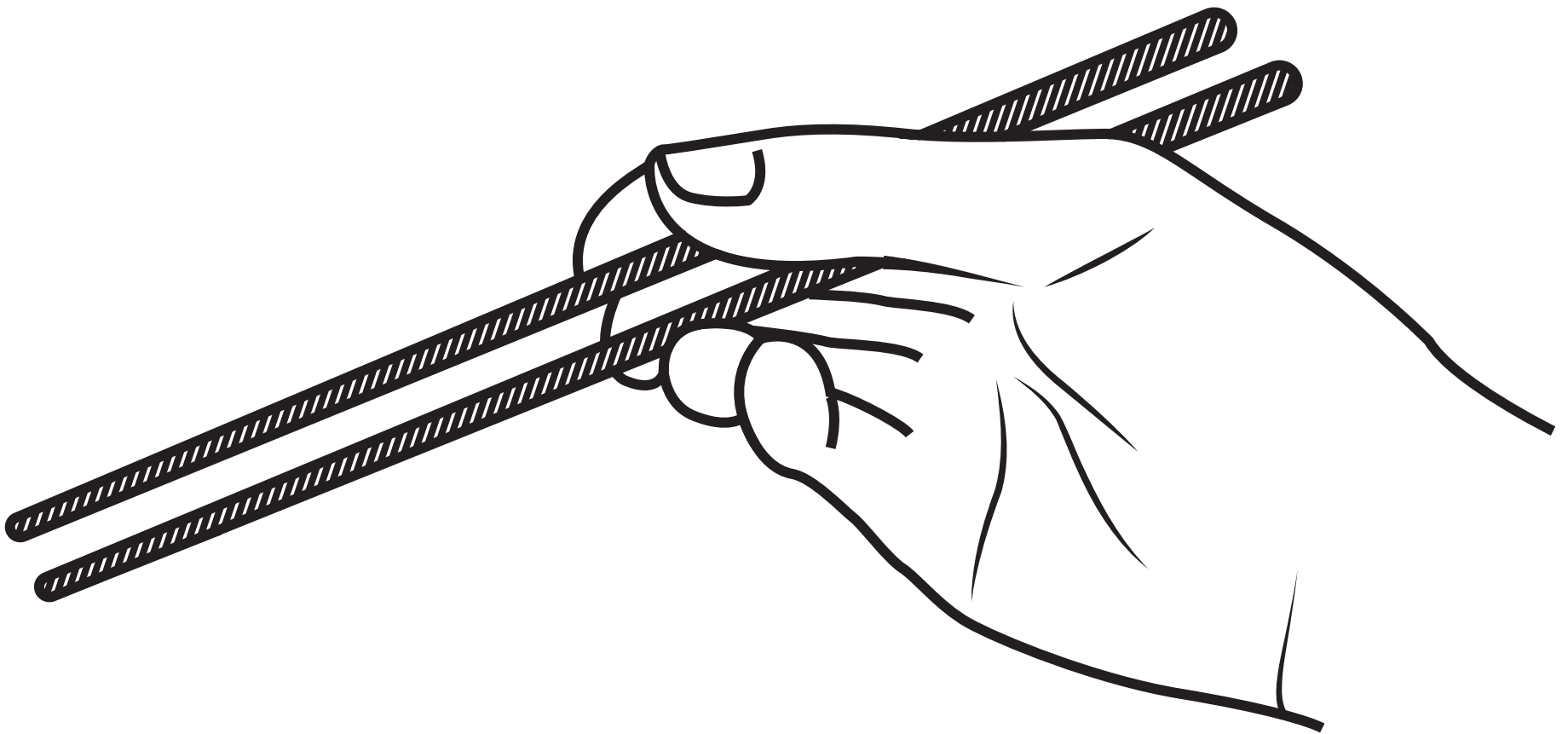



Question 8(d)

FIGURE 16

<b>Source of birch</b>	<b>European forests</b>
<b>Country of manufacture</b>	<b>China</b>
<b>Potential market</b>	<b>Restaurants, takeaway restaurants and homes</b>
<b>Scale of production</b>	<b>Continuous</b>

Question 1(a)

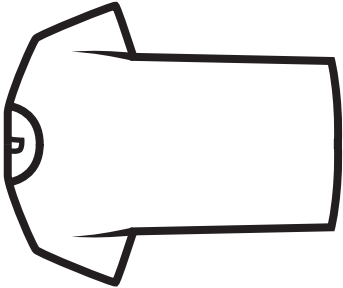
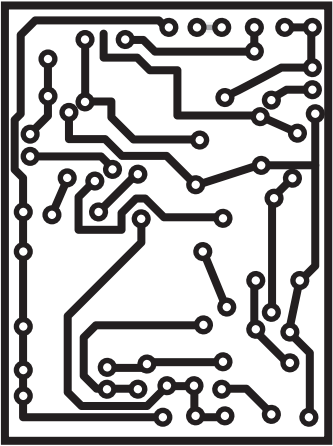
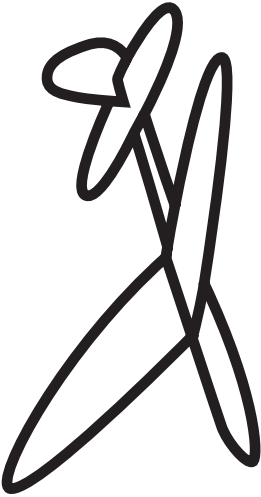
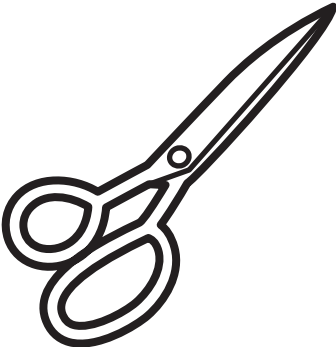

Figure 1

Picture of product	Material and product	Property
	Cotton T-shirt	Soft
	Polyester resin printed circuit board (PCB)	(i) _____
	Balsa wood toy plane	(ii) _____

(continued on the next page)

Turn over

Question 1(a) continued

Picture of product	Material and product	Property
	Stainless steel kitchen scissors	(iii) _____
	Solid white board hardback book cover	(iv) _____

## Question 5(a) – Outline

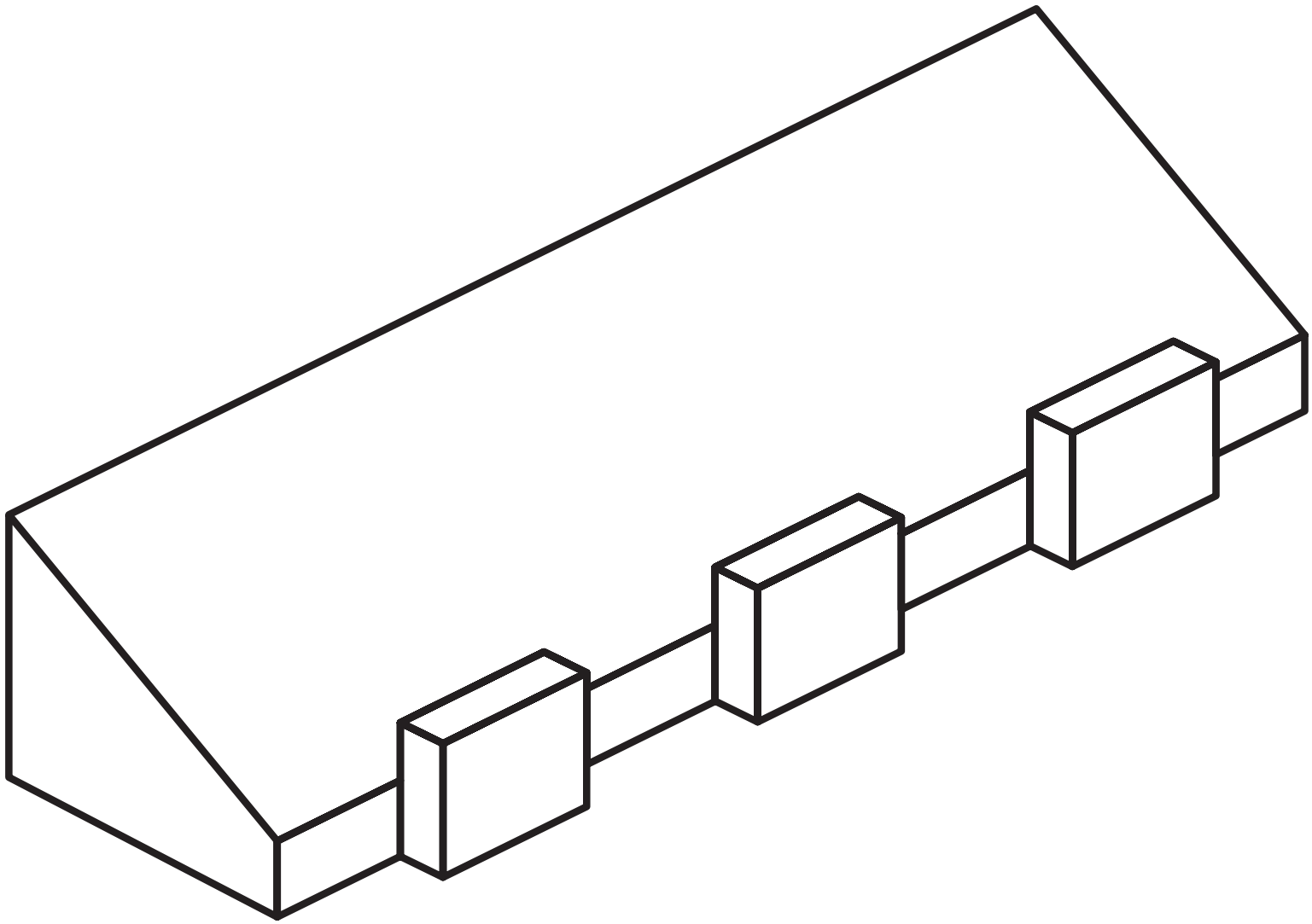

**Question 7(c) continued.**  
**5mm isometric grid**

